

BOTTOM PANS

STANDARD & FLUSH FLOOR

Wear bars, wipers pans & splashguards for RV slide-out rooms, specialized for standard & flush floor rooms.

Contemporary one part design **replaces existing multi-part solutions**

- Reduces labor & assembly costs
- Simplifies sourcing & procurement channels
- Reduces inventory, storage space & complexity
- Replacing metal with plastic improves processing, handling, storage & installation safety
- Simple & cost effective

Modern, inventive design conforms to **technologically-advanced buying** trends

Environmentally-friendly recyclable raw materials

UV protected

Easily adaptable to current models

Made in USA with ISO 9001 quality standards, ISO 14001 environmental standards

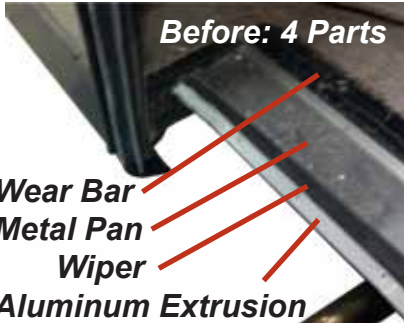
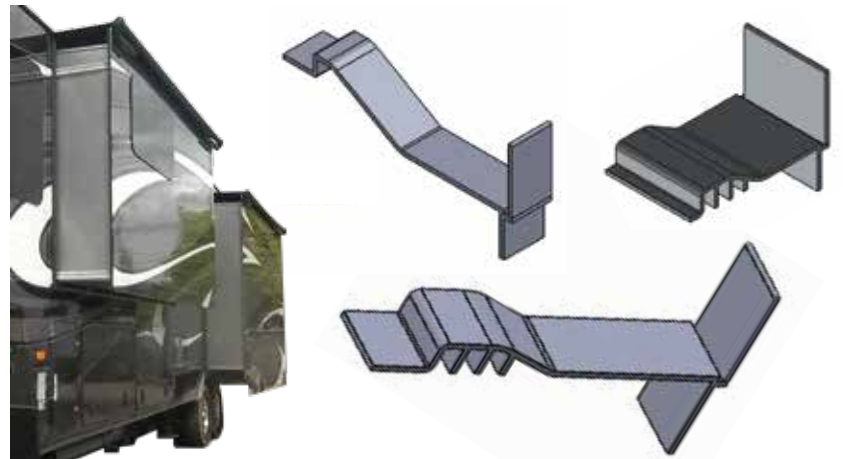

FEATURES

Protects interior flooring from wear & tear as rooms slide in / out

Splashguard **shields road debris & spray**

Cohesive one piece design **eliminates seams**, further protecting against water ingress

Barrier to water, dust, mud, wind, insects & other environmental elements

Long lifetime flexible wipers

- Water removal from moving slide walls during open / close

Heat activated tape to **aid in installation**

- Wall mount support during installation
- Additional weather sealing performance

NEW PRODUCTS

#3084

#3088

#3091

#1676



GENERAL AREAS OF EXPERTISE

- Environmental Seals & Gaskets
- Electromechanical Subassemblies
- EMI Shielding
- RFI Absorption
- Dielectric Insulation
- Electric Conduction
- Static Dissipation
- OLED & LCD Gaskets & Tapes
- Lens Adhesives & Protection
- Wound Care Products
- Metal Stamping
- Multi-Color Graphic Overlays
- Molded Rubber
- Extruded Rubber
- Rubber & Silicone Hoses
- Heat Spreading
- Thermal Management
- Acoustic Damping & Insulation
- Vibration Damping
- Shock Absorption
- Cushioning
- Adhesive Systems
- Fastening Systems
- Extruded Plastic
- Electrical Insulators
- O-Rings



In forms of:

- Open & Closed Cell Foam
- Coated and Conductive Fabrics
- Pressure Sensitive Adhesives
- Metal Foils, Plastic Films
- Sponge
- Plastic
- Dense Rubber



SERVICES

- Raw Material Expertise
- Rapid Quote Response and Prototyping
- Continual Support From Development to Production
- Excellent On-time Delivery
- Highest Quality Service



CERTIFICATIONS

- TS 16949
- ISO 9001
- ISO 13485
- ISO 14001
- RoHS Compliance
- UL Recognized
- ITAR
- AS 9100
- Quality Systems
 - APQP
 - PPAP
 - FMEA
 - SPC
 - MSA
 - GR&R

STANDARD MATERIALS

Include, but not limited to:

- EPDM
- Neoprene
- Silicone
- Nitrile
- Polyethylene
- Polyurethane
- Polypropylene
- Polyimide
- Polycarbonate
- Thermoplastic polyolefin
- Thermoplastic elastomer
- Thermoplastic vulcanizate
- Nylon
- Santoprene
- UHMW
- Cork
- Steel

BOYD

CORPORATION